

5C



Clutch Master Cylinder / Clutch Lever Disassembly and Reassembly

Refer to [Clutch Master Cylinder Assembly Removal and Installation](#).

[Reference: Clutch Control System Components](#)

Disassembly

- 1) Remove the clutch lever position switch (1).
- 2) Remove the lock-nut (2) and clutch lever pivot bolt (3).
- 3) Remove the clutch lever (4).

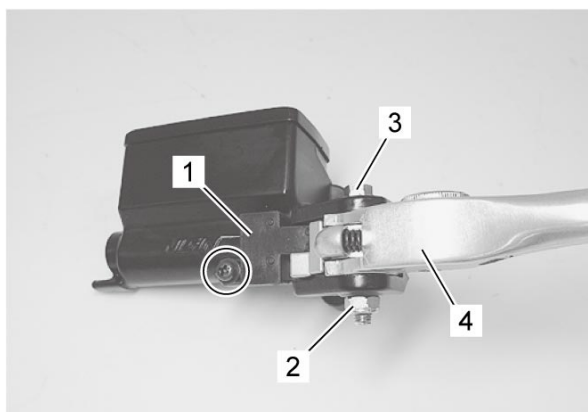

- 4) Remove the bushing (1).



- 5) Remove the reservoir cap (1), plate (2) and diaphragm (3).

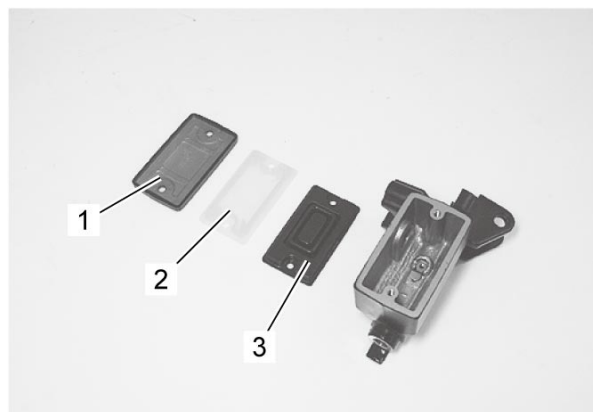

- 6)** Remove the dust boot (1) and push rod (2).
7) Remove the snap ring (3) with the special tool.

Special Tool

09900-06108

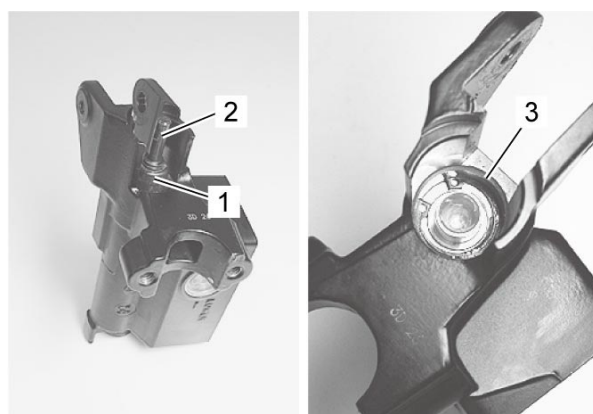

- 8)** Remove the following parts from the master cylinder.
- Stop plate (1)
 - Piston (2)
 - Primary cup (3)
 - Spring (4)

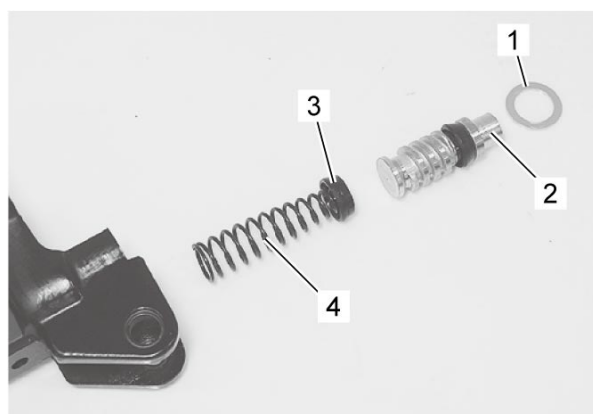



Reassembly

Reference: Clutch Master Cylinder Parts Inspection

Assemble the master cylinder in the reverse order of disassembly. Pay attention to the following points:

NOTICE:

- Wash the master cylinder components with new brake fluid before reassembly.
- Do not wipe the brake fluid off after washing the components.
- When washing the components, use the specified brake fluid. Never use different types of fluid or cleaning solvents such as gasoline, kerosine, etc.
- Apply brake fluid to the master cylinder bore and all of the master cylinder component to be inserted into the bore.

Brake fluid (DOT 4)



- Apply grease to the push rod.

"A": Grease 99000-25100 (SUZUKI SILICONE GREASE)

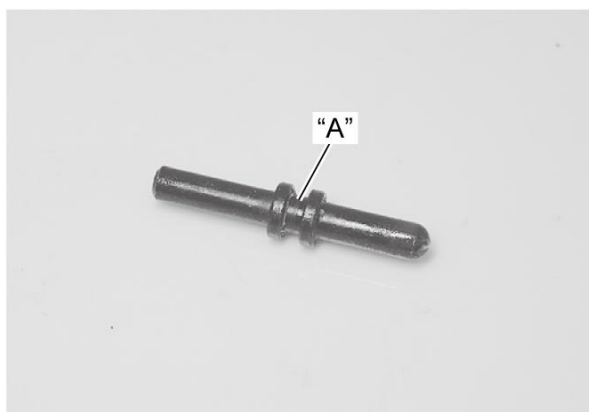

- Install the dust boot (1) to the push rod (2).
- Apply grease to the push rod end.

"A": Grease 99000-25100 (SUZUKI SILICONE GREASE)

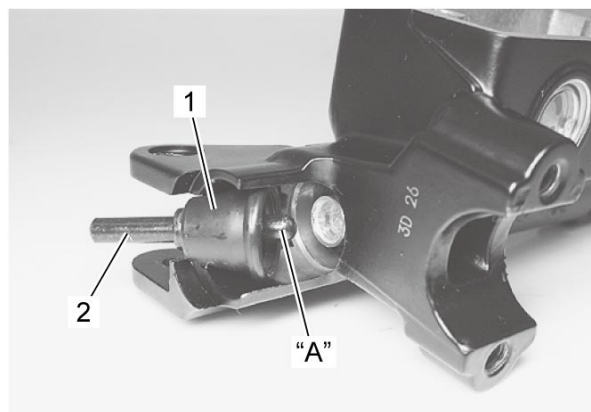

- When installing the clutch lever position switch, align the projection (1) on the switch with the hole (2) in the master cylinder.

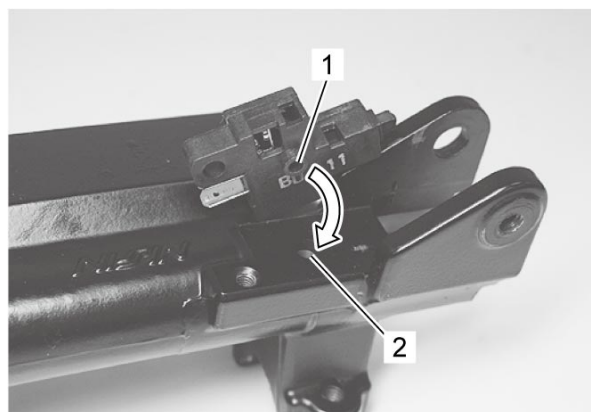

- Apply grease to the clutch lever pivot bolt.
- Apply grease to the bushing (1).

"A": Grease 99000-25100 (SUZUKI SILICONE GREASE)

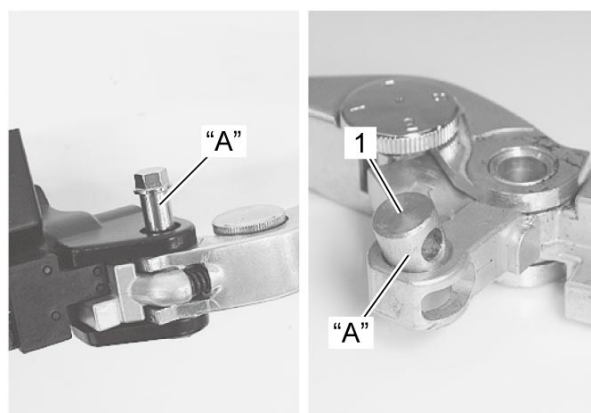

- Tighten the pivot bolt (1) and lock-nut (2) to the specified torque.

Tightening torque

Clutch lever pivot bolt (a): 6 N·m (0.6 kgf-m, 4.5 lbf-ft)

Clutch lever pivot bolt lock-nut (b): 6 N·m (0.6 kgf-m, 4.5 lbf-ft)

